

A ... Seilabhängung variabel
 A ... variable for cable suspension
 A ... pour fixation à fils variable

$A_{\max} = L - 120\text{mm}$

A ... für Deckenmontage/Pendelaufhängung
 A ... for ceiling mounting/pendant suspension
 A ... pour fixation au plafond/suspension pendulaire

$A_{\max} = L - 200\text{mm}$

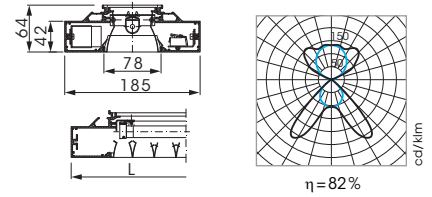

Direkt/indirekt strahlende Spiegelraster-Anbau- und Pendelleuchte, Alu-Profil farblos eloxiert, in 1-, 2- und 3-längiger Ausführung.
Spiegelraster Aluminium hochglanz, rundum entblendet.

Zubehör:
bitte separat bestellen [Seite 5.9-5.10]

Surface mounted or pendant direct/indirect luminaire with mirror louvre, aluminium profile natural anodized, available in single-, dual- and triple-length. Mirror louvre, highly polished aluminium, glare free.

Accessories:
please order separately [page 5.9-5.10]

Luminaire apparent et suspendu à écran miroité pour éclairage direct/indirect, profilé en aluminium anodisé nature, en version mono, duo et triple longueurs.

Ecran en aluminium miroité poli brillant, non-éblouissant de toutes les directions.

Accessoires:
veuillez s.v.p. commander séparément [page 5.9-5.10]

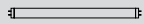
Art. No.		L [mm]
1-längig single-length mono longueur		
4010HB-1287	1 x 1 x 28 W T5	1300
4010HB-1547	1 x 1 x 54 W T5	1300
4010HB-1357	1 x 1 x 35 W T5	1600
4010HB-1807	1 x 1 x 80 W T5	1600

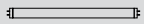
Art. No.		L [mm]
2-längig dual-length duo longueur		
4020HB-2287	2 x 1 x 28 W T5	2493
4020HB-2547	2 x 1 x 54 W T5	2493
4020HB-2357	2 x 1 x 35 W T5	3093
4020HB-2807	2 x 1 x 80 W T5	3093

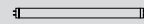
Art. No.		L [mm]
3-längig triple-length triple longueur		
4030HB-3287	3 x 1 x 28 W T5	3686
4030HB-3547	3 x 1 x 54 W T5	3686
4030HB-3357	3 x 1 x 35 W T5	4586
4030HB-3807	3 x 1 x 80 W T5	4586

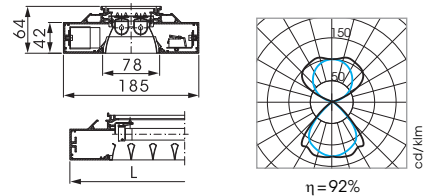

Direkt/indirekt strahlende Spiegelraster-Anbau- und Pendelleuchte, Alu-Profil farblos eloxiert, in 1-, 2- und 3-längiger Ausführung.
Spiegelraster Aluminium hochglanz, rundum entblendet.

Zubehör:
bitte separat bestellen [Seite 5.9-5.10]

Surface mounted or pendant direct/indirect luminaire with mirror louvre, aluminium profile natural anodized, available in single-, dual- and triple-length. Mirror louvre, highly polished aluminium, glare free.

Accessories:
please order separately [page 5.9-5.10]

Luminaire apparent et suspendu à écran miroité pour éclairage direct/indirect, profilé en aluminium anodisé nature, en version mono, duo et triple longueurs.

Ecran en aluminium miroité poli brillant, non-éblouissant de toutes les directions.

Accessoires:
veuillez s.v.p. commander séparément [page 5.9-5.10]

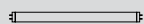
Art. No.		L [mm]
1-längig single-length mono longueur		
4010HB-2287	1 x 2 x 28 W T5	1300
4010HB-2547	1 x 2 x 54 W T5	1300
4010HB-2357	1 x 2 x 35 W T5	1600
4010HB-2807	1 x 2 x 80 W T5	1600

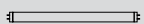
Art. No.		L [mm]
2-längig dual-length duo longueur		
4020HB-4287	2 x 2 x 28 W T5	2493
4020HB-4547	2 x 2 x 54 W T5	2493
4020HB-4357	2 x 2 x 35 W T5	3093
4020HB-4807	2 x 2 x 80 W T5	3093

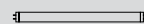
Art. No.		L [mm]
3-längig triple-length triple longueur		
4030HB-6287	3 x 2 x 28 W T5	3686
4030HB-6547	3 x 2 x 54 W T5	3686
4030HB-6357	3 x 2 x 35 W T5	4586
4030HB-6807	3 x 2 x 80 W T5	4586

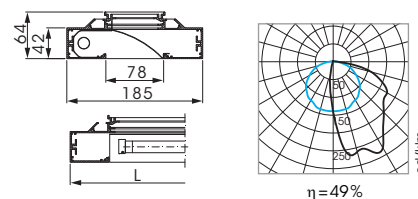
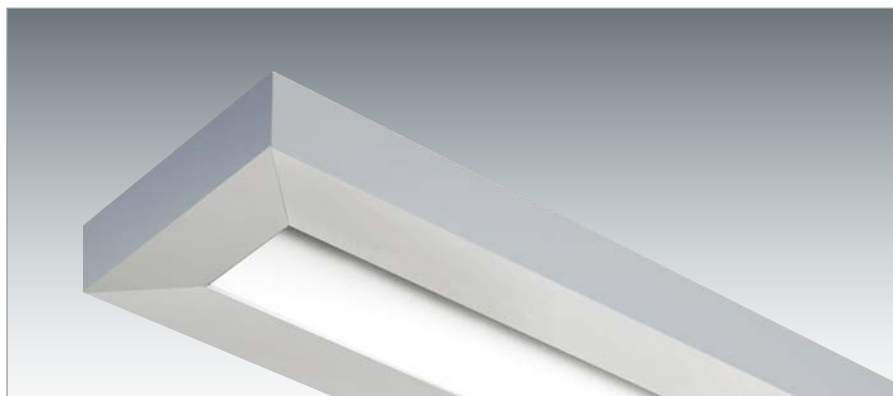

Asymmetrisch strahlende Anbau- und Pendelleuchte, Alu-Profil farblos eloxiert, in 1-, 2- und 3-längiger Ausführung.
Reflektor asymmetrisch, Aluminium matt.

Asymmetrically illuminating surface mounted or pendant luminaire, aluminium profile natural anodized, available in single-, dual- and triple-length.
Asymmetrical reflector, aluminium matt.

Luminaire apparent et suspendu pour éclairage asymétrique, profilé en aluminium anodisé nature, en version mono, duo et triple longueurs.
Réflecteur asymétrique, en aluminium mat.

Zubehör:
bitte separat bestellen [Seite 5.9-5.10]

Accessories:
please order separately [page 5.9-5.10]

Accessoires:
veuillez s.v.p. commander séparément [page 5.9-5.10]

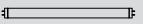
Art. No.		L [mm]
1-längig single-length mono longueur		
4060AS-1287	1 x 1 x 28W T5	1300
4060AS-1547	1 x 1 x 54W T5	1300
4060AS-1357	1 x 1 x 35W T5	1600
4060AS-1807	1 x 1 x 80W T5	1600

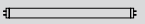
Art. No.		L [mm]
2-längig dual-length duo longueur		
4070AS-2287	2 x 1 x 28W T5	2493
4070AS-2547	2 x 1 x 54W T5	2493
4070AS-2357	2 x 1 x 35W T5	3093
4070AS-2807	2 x 1 x 80W T5	3093

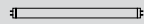
Art. No.		L [mm]
3-längig triple-length triple longueur		
4080AS-3287	3 x 1 x 28W T5	3686
4080AS-3547	3 x 1 x 54W T5	3686
4080AS-3357	3 x 1 x 35W T5	4586
4080AS-3807	3 x 1 x 80W T5	4586

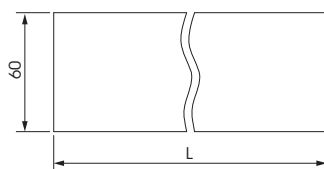
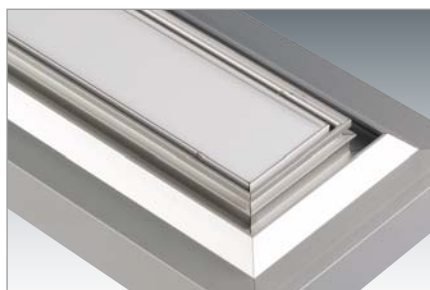

Blechabdeckung weiß für reine Direktstrahlung.

White cover plate for direct illumination.

Art. No.		L [mm]
4010-C19	28W/54W T5	1175
4010-C29	35W/80W T5	1475

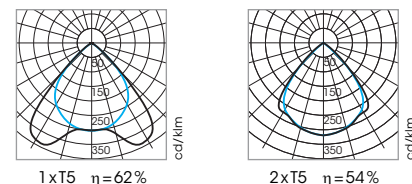

Cache en tôle blanche pour un rayonnement direct.

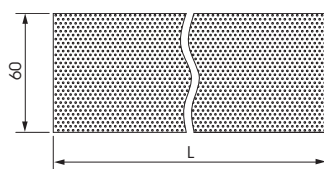

Lochblechabdeckung weiß für die Blendungsbegrenzung des Indirekt-Anteiles.

White perforated cover plate for glare reduction of the indirect section.

Art. No.		L [mm]
4010-C39	28W/54W T5	1175
4010-C49	35W/80W T5	1475

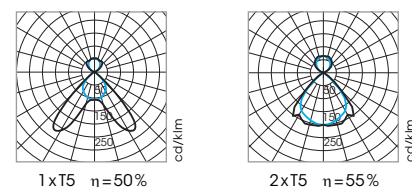

Cache en tôle perforée blanche pour limiter l'éblouissement de la partie indirecte.

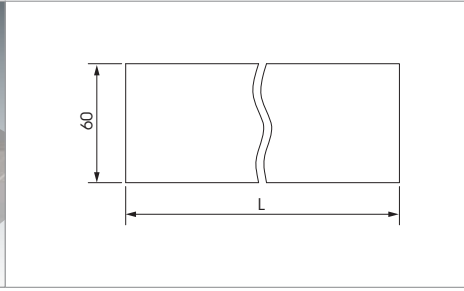

Acrylglasabdeckung opal für die Blendungsbegrenzung des Indirekt-Anteiles.

Opal acrylic glass cover for glare reduction of the indirect section.

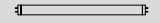
Art. No.		L [mm]
4010-G19	28 W/54 W T5	1172
4010-G29	35 W/80 W T5	1472

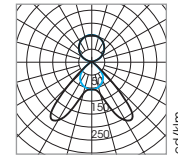

1xT5 $\eta=65\%$

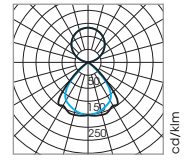

2xT5 $\eta=76\%$

Cache en verre acrylique opale pour limiter l'éblouissement de la partie indirecte.

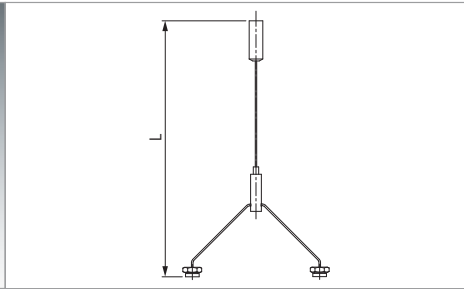
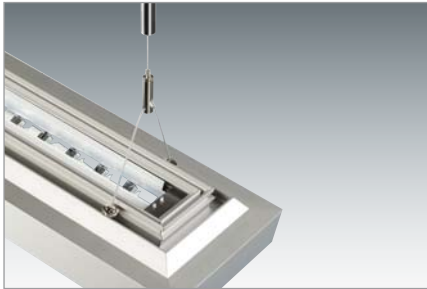

Dreipunkt-Seilaufhängung. 2 Stück für 1-längige Leuchte, mindestens 2 Stück für 2-längige Leuchte, mindestens 3 Stück für 3-längige Leuchte.

Three-point cable suspension. 2 units for single-length luminaires, minimum of 2 units for double-length luminaires, minimum of 3 units for triple-length luminaires.

Art. No.		L [mm]
4011		max. 2000

Câble de suspension à trois points. 2 pièces pour luminaires mono longueur, minimum 2 pièces pour luminaires duo longueur, minimum 3 pièces pour luminaires triple longueur.

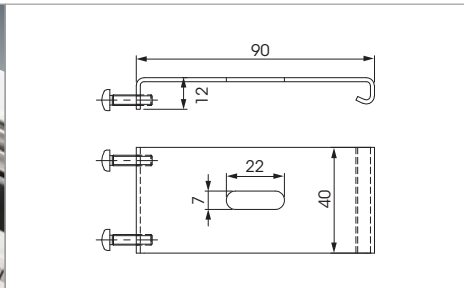

Deckenhalterung. 2 Stück für 1-längige Leuchte, mindestens 2 Stück für 2-längige Leuchte, mindestens 3 Stück für 3-längige Leuchte.

Ceiling mounting bracket. 2 units for single-length luminaires, minimum of 2 units for double-length luminaires, minimum of 3 units for triple-length luminaires.

Art. No.	
4014	nur mit Blechabdeckung 0-4010-... zu verwenden
	for use only with 0-4010 plate cover
	seulement à utiliser avec la tôle blanche 0-4010-...

Support de fixation au plafond. 2 pièces pour luminaires mono longueur, minimum 2 pièces pour luminaires duo longueur, minimum 3 pièces pour luminaires triple longueur.

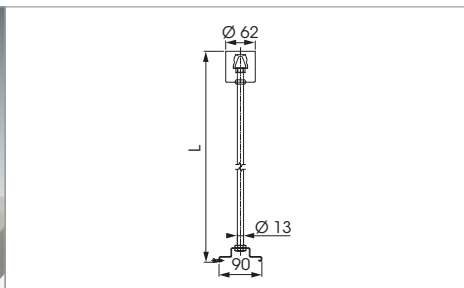

Rohrpendel. 2 Stück für 1-längige Leuchte, mindestens 2 Stück für 2-längige Leuchte, mindestens 3 Stück für 3-längige Leuchte.

Pendant tubing. 2 units for single-length luminaires, minimum of 2 units for double-length luminaires, minimum of 3 units for triple-length luminaires.

Art. No.		L [mm]
4015		max. 500

Tube pendulaire. 2 pièces pour luminaires mono longueur, minimum 2 pièces pour luminaires duo longueur, minimum 3 pièces pour luminaires triple longueur.