





**AUSFÜHRUNGEN**

**FORMS**

***FORMES***

## FORMEN

Die Metaldeckenplatte wird immer von oben gesehen. Das ist wichtig bei asymmetrischen Ausführungen und bei der Anwendung von Durchbrüchen.

Längsseitige Aufkantungshöhe, wenn nichts angegeben, nach statischen Erfordernissen.

### Rechteck

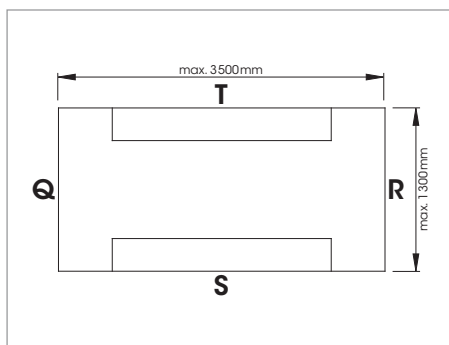

## FORMS

In the drawings, metal ceiling panels are always seen from above. That is important for asymmetric versions and where there are apertures.

Where no dimension is given, the flange height on the long side is chosen to meet structural requirements.

### Rectangular

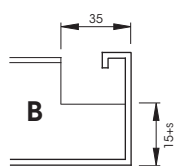

## FORMES

*Le panneau de plafond métallique est toujours vu de dessus. Cela est important pour les exécutions asymétriques et l'utilisation de passages.*

*Hauteur de retour côté longueur, sauf autres indications, selon exigences statiques.*

### Rectangle

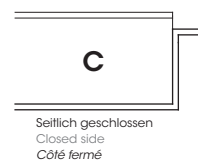

### Quadrat

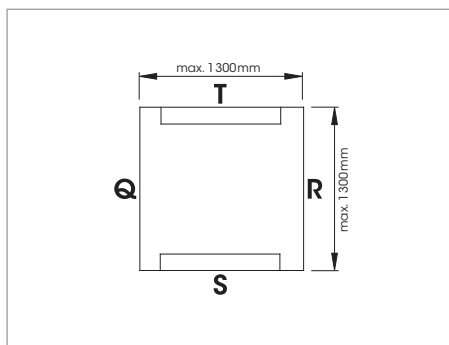

### Square

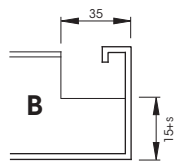

### Carré

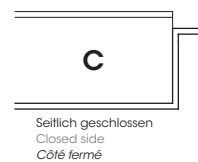

### Einseitiges Trapez

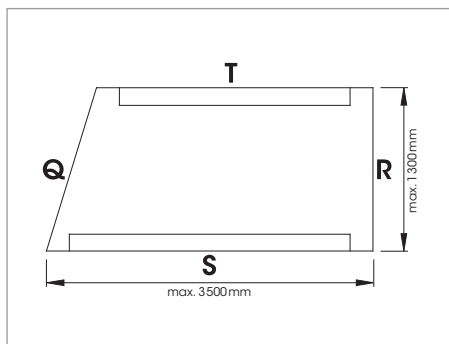

### Trapezium, one end

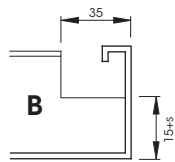

### Trapèze rectangle

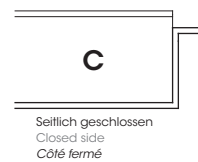

**Trapez**

**Trapezium**

**Trapèze**

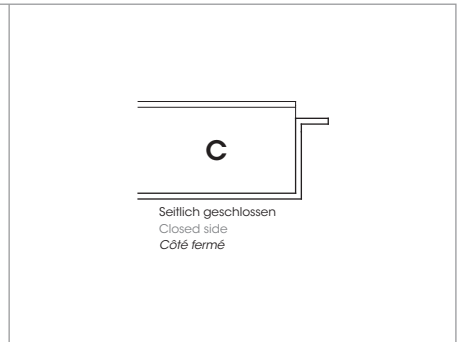
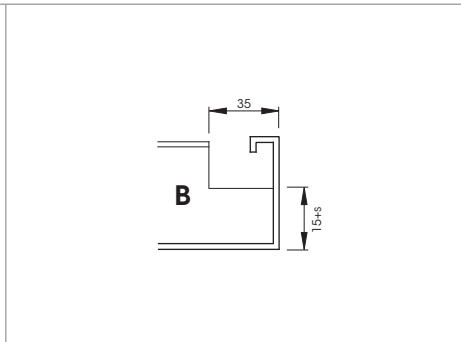
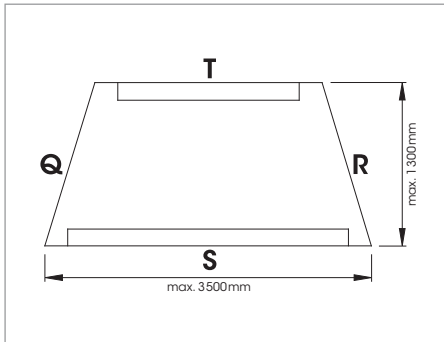

**Dreieck**

**Triangle**

**Triangle**

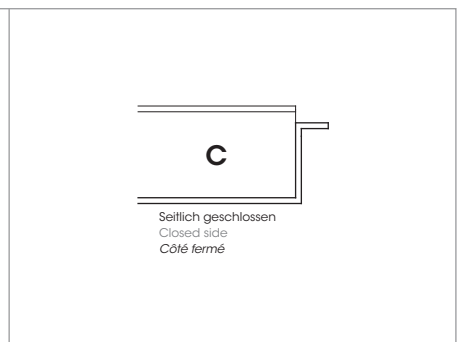
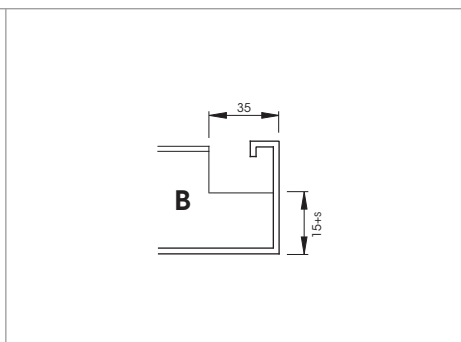
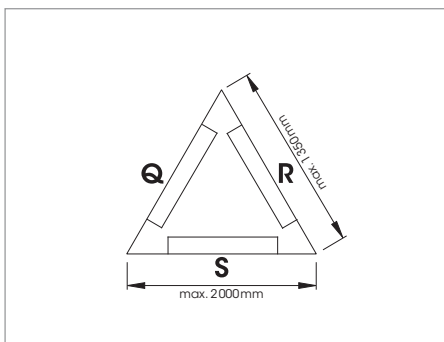

STIRNSEITEN FRONT SIDES COTE LARGEUR

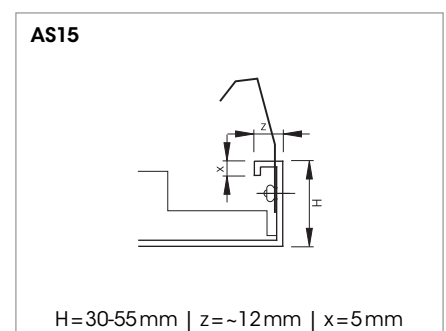
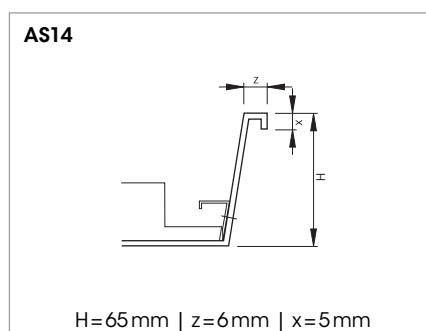
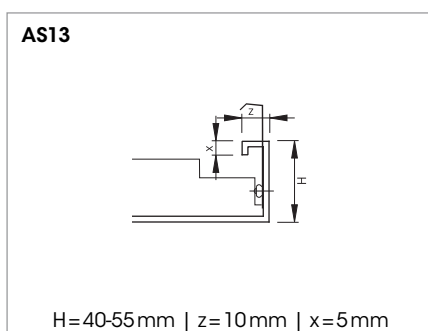
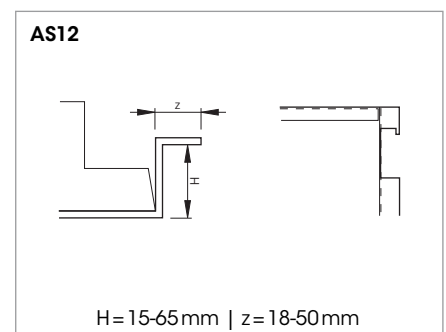
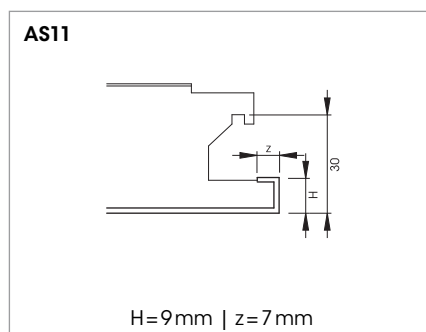
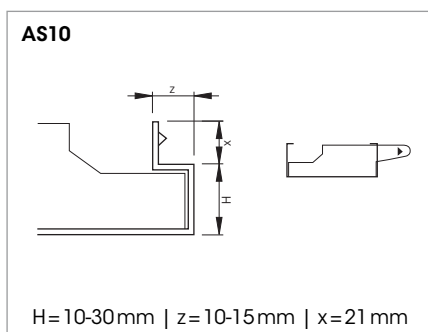
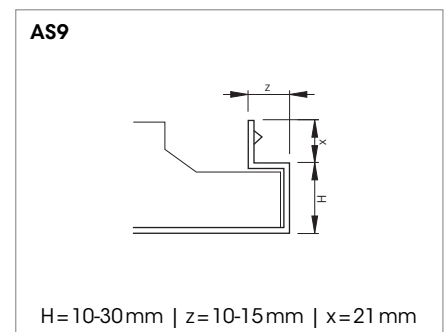
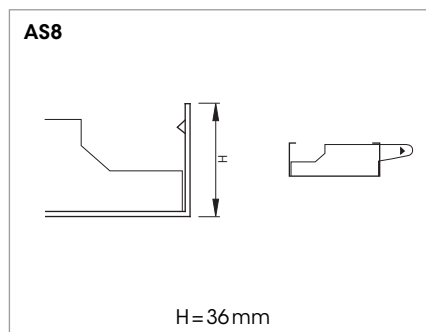
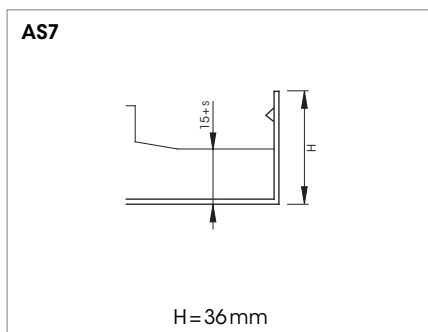
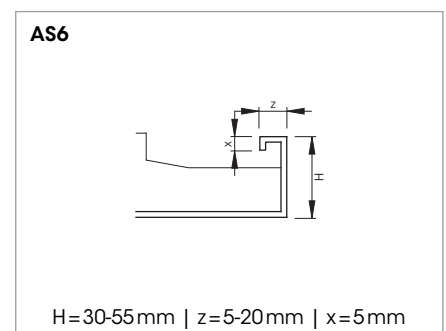
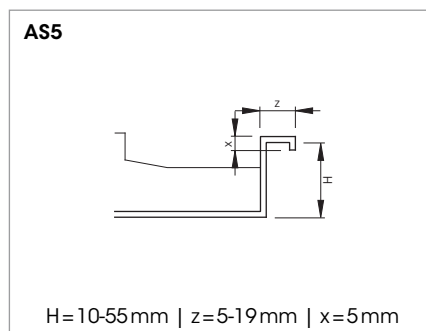
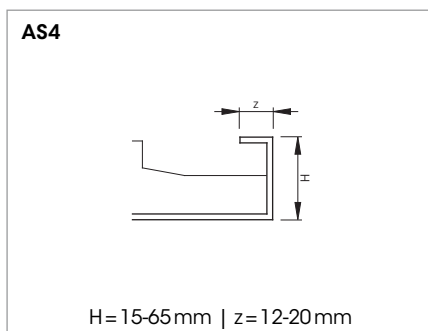
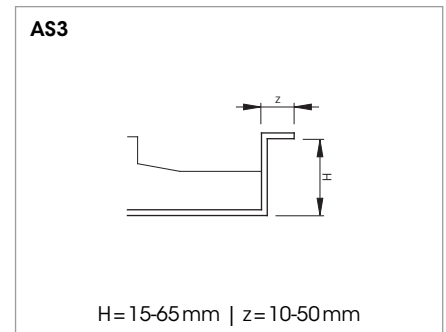
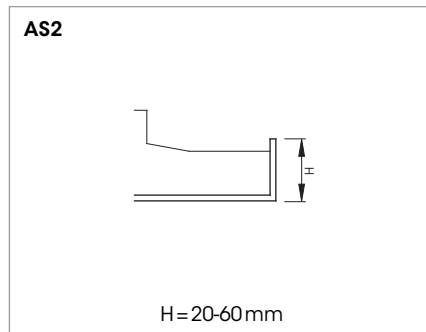
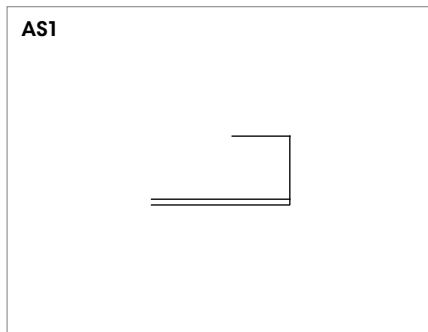

STIRNSEITEN FRONT SIDES COTE LARGEUR

**AS16**

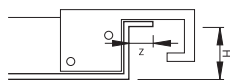

H=30-65mm | z=7-19mm

**AS17**

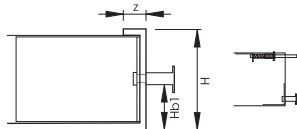

H=30-60mm | z=7-19mm | Hb1=10-50mm

**AS18**

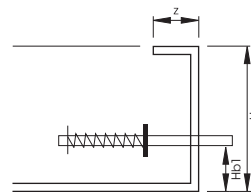

H=30-60mm | z=7-19mm | Hb1=10-50mm

**AS19**

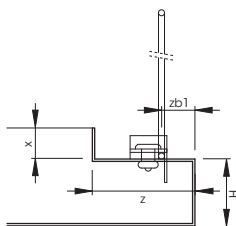

H=17-25mm | z=29mm | x=11-19mm  
zb1=10mm

**AS 20**

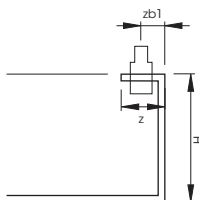

H=30-60mm | z=18-19mm | zb1=9,5mm

**AS21**

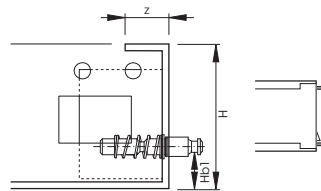

H=40-65mm | z=7-12mm | Hb1=8,5mm

**AS22**

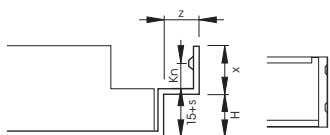

H=15mm | z=10mm  
x=17mm | Kn=11,2mm

**AS23**

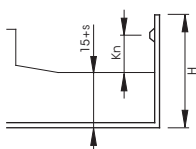

H=32mm | Kn=11,2mm

**AS26**

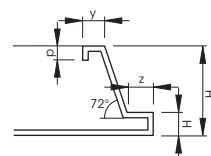

H=12mm | H<sub>A</sub>=55mm | z=16mm  
y=12mm | p=8mm

**AS27**

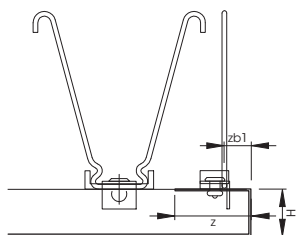

H=17-25mm | z=29mm | zb1=10mm

**AS29**

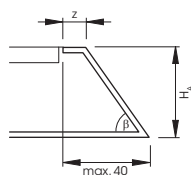

H<sub>A</sub>=45-50mm | z=12-20mm | β=50-55°

LÄNGSSEITEN LONG SIDES COTE LONGUEUR

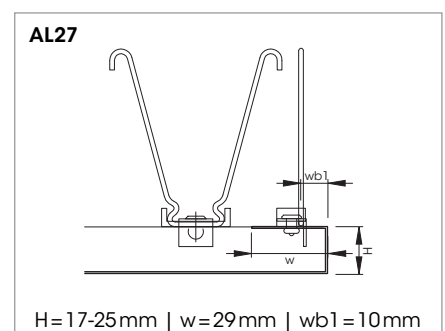
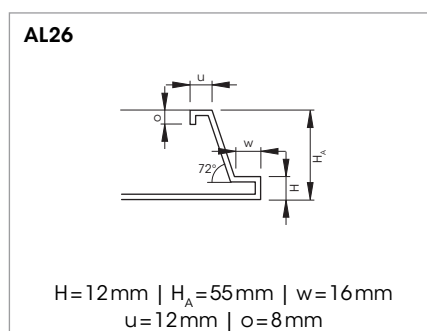
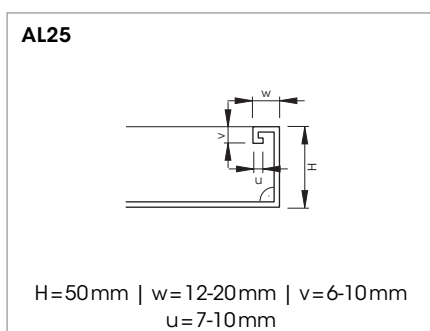
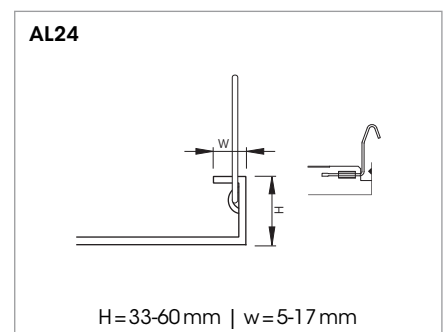
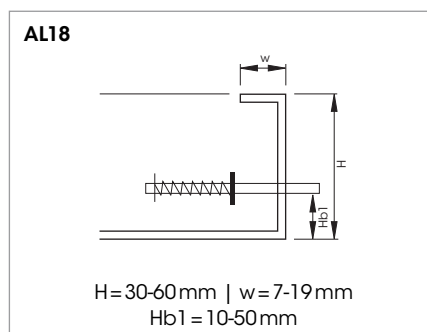
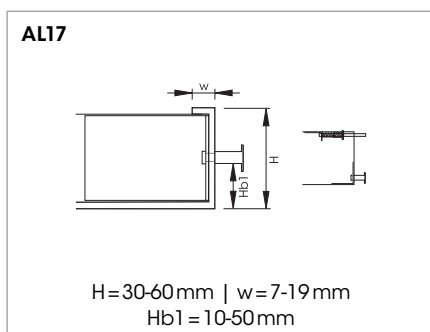
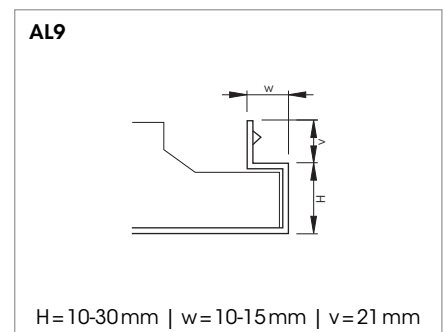
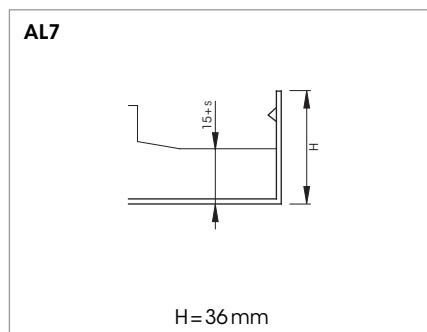
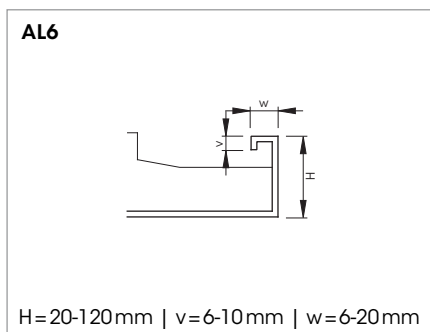
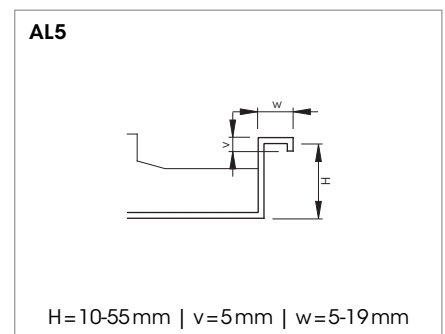
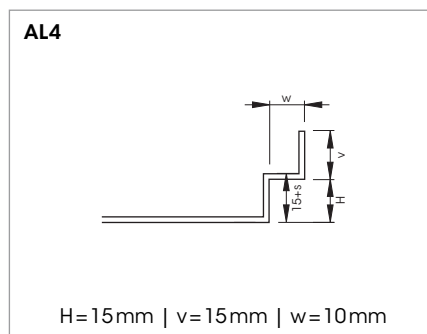
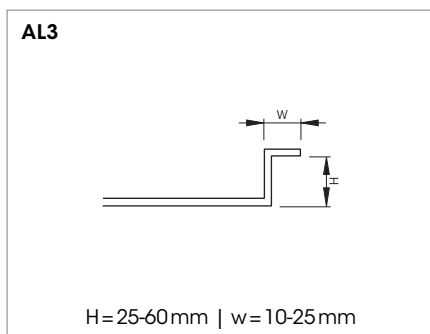
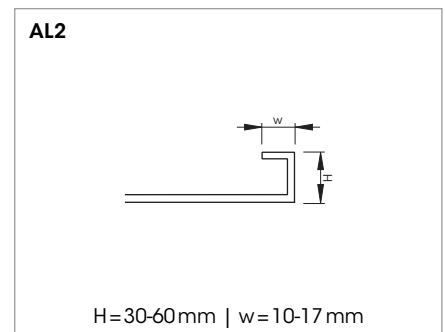
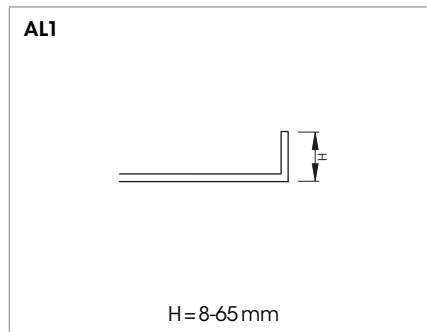
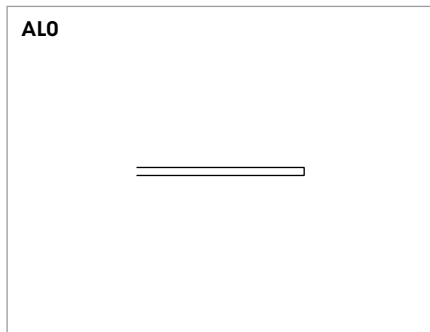

LÄNGSSEITEN LONG SIDES COTE LONGUEUR

**AL28**

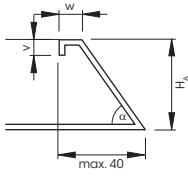

$H_A = 45-50 \text{ mm}$  |  $w = 12-20 \text{ mm}$   
 $v = 6-9 \text{ mm}$  |  $\alpha = 50-55^\circ$